



SUNSEEKER PORTOFINO 47

*The world's finest luxury motoryachts*

# PORTOFINO 47

**STYLE:** SPORTS CRUISER

**ACCOMMODATION:** UP TO 4 GUESTS

**PERFORMANCE:** UP TO 34 KNOTS

BRINGING THE BIG-BODIED AND OUTDOOR-LIFE PORTOFINO THEME BANG UP TO DATE, THE PORTOFINO 47 CAN BE SPECIFIED EITHER AS AN OPEN COCKPIT CRAFT OR TOPPED WITH THE STYLISTIC SLIDING HARD TOP AS ON THE BIGGER PORTOFINO 53. THE NEW DETAILING ALSO INTRODUCES THE SUBMERGING BATHING PLATFORM WHICH DOUBLES AS SLIP FOR THE TENDER. THE ACCOMMODATION BELOW REVOLVES AROUND A LARGE SALOON AND WELL-EQUIPPED GALLEY WITH A MASTER STATEROOM FORWARD AND A TWIN BED CABIN AFT, BOTH EN SUITE. THE COCKPIT ABOVE INCORPORATES COMPANIONABLE SEATING FORWARD ADJACENT TO THE HELM STATION WITH A SECOND SOCIAL AREA AFT WITH SEATING, WETBAR AND SUNPAD.

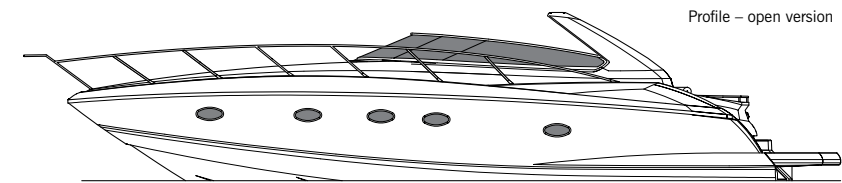

Profile – open version

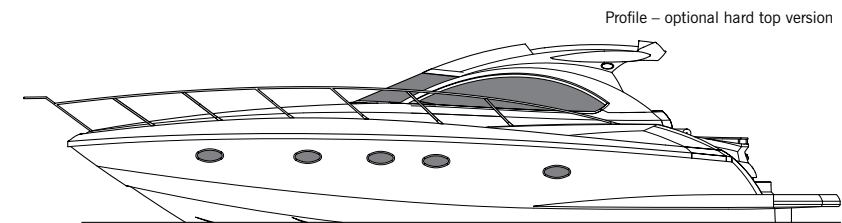

Profile – optional hard top version

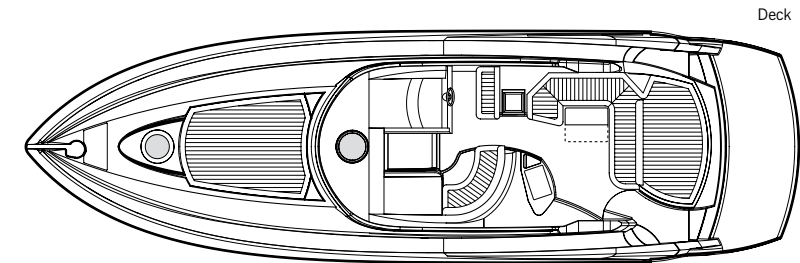

Deck

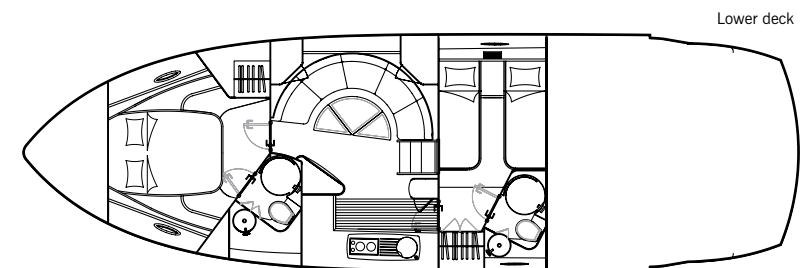

Lower deck

## PRINCIPAL CHARACTERISTICS

<b>Length overall – (incl. pulpit)</b>	14.95m	49'1"
<b>Length hull – (incl. platform)</b>	14.18m	46'6"
<b>Length waterline – (@ half load)</b>	10.90m	35'9"
<b>Beam – (maximum)</b>	4.30m	14'1"
<b>Height above waterline – (excl. navigation mast)</b>	4.10m	13'5"
<b>Draft – (maximum @ full load)</b>	1.20m	3'11"
<b>Displacement – (@ half load)</b>	16400kg	36146lb
<b>Fuel capacity</b>	1310 litres	288 GB gal. 346 US gal.
<b>Fresh-water capacity</b>	340 litres	75 GB gal. 90 US gal.
<b>Propulsion</b>	Twin FP props in tunnels/IPS	

<b>Engine options</b>	up to 1150 PS (total)
<b>Fuel options</b>	Diesel
<b>Generators</b>	Standard 4kW @ 50Hz (Euro) 9kW @ 60Hz (US) Upgrade 7kW @ 50Hz (Euro)
<b>Maximum speed</b>	up to 34 knots*
<b>Cruising speed</b>	up to 22 knots*
<b>Range</b>	up to 200 nautical miles*

All principal characteristics and specifications are provisional and subject to final specification.



# PORTOFINO 47

## PRINCIPAL FEATURES

**Lifting platform**  
**Electric anchor winch with deck and cockpit controls**  
**Hot and cold swimming shower**  
**Full wetbar with hot and cold water**  
**Coolbox**  
**Large cockpit table**  
**Depth sounder**  
**VHF radio**  
**Flatscreen television in all cabins**  
**DVD player in saloon**  
**Radio/CD**  
**Electric refrigerator**  
**Electric hob and microwave**  
**Hot and cold water system**  
**Automatic fire extinguishers**  
**Automatic bilge pump**  
**Radar**  
**Autopilot**  
**Generator**  
**Teak bathing platform and step**  
**AC shorepower/battery charger**  
**Vacuum toilets and holding tank**

All items included in standard specification.

**US specification includes:**  
**Air-conditioning**  
**Upgraded generator**  
**US Coast Guard build regulations**  
**US specification appliances**

## STANDARD SPECIFICATIONS

### 1 Construction

Hand-laid GRP  
 Gel coat including stripes  
 Vinylester skin coat with powderbound mat  
 Stitched multi-axial reinforced single skin bottom  
 Balsa cored hull topsides  
 PVC foam cored deck and superstructure  
 Hull stiffened with longitudinal stringers supported by transverse bulkheads and floors

### 2 Deck

Moulded non-slip deck finish  
 Fittings all in stainless steel  
 Pulpit and cockpit rails  
 Stainless steel fendering with rubber insert  
 10 stainless steel cleats  
 Curved stainless steel framed windscreen on open version  
 Electric anchor winch and capstan with deck and cockpit controls  
 Stainless steel bow roller with anchor stop  
 Delta anchor and 30m chain (galvanised)  
 Chain locker with fender storage  
 IMCO navigation lights  
 Fuel filler  
 Fresh-water filler  
 Foldaway swimming ladder  
 Teak-laid bathing platform and steps  
 Hydraulic lifting platform  
 Hot and cold swimming shower  
 Ensign staff and socket  
 Fender tie bar under anchor locker lid

### 3 Cockpit

Self draining  
 Safety door  
 Full wetbar with hot and cold water, cool box  
 Dinette seating  
 Fold-out table  
 Storage beneath seating  
 Folding helm seat  
 Curved co-pilot seating area  
 Chart table  
 Sunbather  
 Large storage locker under sunbather  
 Glass holders  
 Overhead cockpit lights 12v  
 Low-level cockpit lights  
 Waterproof carpet

### 4 Helm console

Contoured console with burr type walnut fascia  
 Radar  
 Autopilot  
 VHF radio  
 Wood rimmed steering wheel  
 Single lever controls  
 Full analogue engine instrumentation  
 Electronic speedlog  
 Depth sounder  
 Fuel gauge  
 Fresh-water gauge  
 Compass  
 Horn  
 Trim tab controls  
 Waterproof plug and socket  
 2 windscreen wipers and washers  
 Fire extinguisher  
 Glass holders

### 5 Main cabin/saloon

Large dinette  
 Flatscreen television  
 DVD player  
 Radio/CD with speakers in cabin and cockpit  
 Stowage beneath seats and table  
 Scatter cushions  
 Drinks cupboard  
 Overhead halogen lights 12v  
 Opening portholes with mosquito screens and curtains  
 Deck hatch  
 Main switch and circuit breaker panel (AC/DC)  
 Double AC socket  
 Choice of lacquered interior finishes and veneers  
 Fitted carpet

### 6 Galley

Electric refrigerator  
 Electric twin hob  
 Microwave  
 6 place crockery set  
 6 place cutlery set  
 Cupboard storage and drawers  
 Opening porthole with mosquito screen and blind  
 Double AC socket  
 Hand-held fire extinguisher  
 First aid kit  
 Rubbish bin



1. Deck saloon
2. Saloon
3. Owner's stateroom

#### 7 Master stateroom

Double bed  
Storage beneath  
Drawers in bed end  
2 reading lights 12v  
Hanging wardrobe  
Overhead halogen lighting  
2 x opening portholes with mosquito screen and curtains  
Deck hatch  
Door to toilet/shower  
Double AC socket  
Flatscreen television  
Fitted carpet

#### 8 Master en suite toilet and bathroom

Wash basin  
Taps and accessories  
Mirrored vanity unit  
Toothbrush glass holder  
Soap dish  
Towel ring  
Stowage cupboard  
Vacuum toilet  
Shower compartment  
Overhead lights  
Opening porthole with mosquito screen and curtain  
Razor socket 240/110v

#### 9 Twin aft cabin

Two single berths  
Under-berth storage and drawers  
Hanging wardrobe  
Storage cupboard  
Overhead halogen lighting  
2 reading lights  
Opening porthole with mosquito screen  
Double AC socket  
Flatscreen television  
Fitted carpet

#### 10 En suite toilet compartment

Wash basin  
Taps and accessories  
Mirrored vanity unit  
Toothbrush glass holder  
Soap dish  
Towel ring  
Shower  
Overhead lights  
Vacuum toilet  
Opening porthole with mosquito screen and curtain  
Razor socket 240/110v

#### 11 Engine compartment and ancillaries

Twin engines with close coupled  
V-drive gearbox  
Sound insulation throughout engine room  
2 x aluminium fuel tanks with electric senders  
Automatic fire extinguishers  
Automatic bilge pump  
Separate fuel filters/water separators  
Extractor fans  
Aluminium fresh-water tank with electric sender  
Fresh-water pressure system  
Hot water tank

#### 12 Electrical system

Slow speed generator with underwater silent exhaust system  
AC dockside connection  
Galvanic isolator  
24v DC electrical system with full circuit breaker protection  
4 x engine batteries  
4 x domestic batteries  
2 x generator batteries  
Alternator split charging system  
Battery switches controlled from locker in cockpit  
Battery charger  
Water heater  
AC sockets throughout the boat

#### 13 Underwater gear

Direct shaft drive through half tunnels  
4-blade NAB bronze propellers  
Bronze P-brackets  
2 x 2" stainless steel Temet 25 shafts  
Dripless shaft logs with spare seals  
High-performance bronze rudders and struts  
Seawater strainers – 2 x main engines/  
1 x generator  
Seacocks on all underwater fittings  
Full cathodic bonding system to zinc anodes  
Stainless steel hydraulic trim tabs 24v

#### 14 Miscellaneous

2 sets towels  
2 x mooring warps  
6 x fenders

#### 15 Optional extras

Opening hard top  
Air-conditioning  
Upgraded generator  
Teak cockpit  
Bow thruster

#### US specification includes:

Air-conditioning  
Upgraded generator  
US Coast Guard build regulations  
US specification appliances



\*Every attempt has been made to give accurate information, but performance and range figures are estimates given as a guide only. Dirt or growth on the hull, tuning of the engines, size, make of engines fitted, damage to propellers, the temperature of the air and water, the weight of fuel, water, stores, number of people, propeller pitch, quality of fuel and other matters, can all affect a boat's performance and range. For these and other reasons we can give no performance, range or other guarantees, and neither such guarantees nor anything contained herein constitutes an offer of contract or any representation or agreement, or may otherwise be relied upon. The photographs and artist's impressions in this brochure are of existing models in the Sunseeker range. There may be items shown in these photographs and artist's impressions that are not included in the standard inventory of the models shown. Specifications contained on the web site are samples only and should not be relied upon and may refer to models only intended for sale in a particular territory and not generally. No guarantee is given that any model will be available in any territory; however by contacting us we can advise you of models that are likely to be available in each territory.

Actual specifications will be provided when a sales order or enquiry is placed with us or our approved Sunseeker dealer. Specifications for models sold in different markets may vary and specifications and models may be changed or withdrawn at any time without prior notice. The individual specification for each vessel will be agreed as part of the sale contract between the purchaser and the Sunseeker dealer. Dealers and distributors are independently owned and operated entities, and therefore Sunseeker dealers and distributors are not owned by Sunseeker International Limited or any subsidiaries or other related entity of this company nor are they their agents. Therefore they have absolutely no authority to commit Sunseeker International Limited, or any subsidiary or other related entities of Sunseeker International Limited to any pledge, contract or agreement in any form or by any means unless first accepted in writing by Sunseeker International Limited. In some examples herein Sunseeker have referred to measurements, specifications or other details applicable to a particular territory and no guarantee is given that these are applicable to your territory. For ease of reference we have, in some cases, referred to "we" or "Sunseeker" and these terms should be taken to mean Sunseeker International Limited.



www.sunseeker.com

#### Awards

Sunseeker's success over the years is clearly underlined by the following list of national and international awards and achievements.

2009	Sydney Boat Show 2009	Display of Excellence	2002	Entrepreneur of the Year Award	Robert Braithwaite MBE
2009	Croatia Boat Show 2009	Predator 92 Sport – best in class	2001	Best Power Design Award	105 Yacht, The Superyacht Society
2009	Croatia Boat Show 2009	30 Metre Yacht – best in class	2001	Best Power Interior Award	105 Yacht, The Superyacht Society
2009	Croatia Boat Show 2009	Best boat show stand	2001	President's Award	Southern California Marine Association
2008	UK Motor Boat of the Year Awards 2008	Manhattan 60	2000	Queen's Award for Enterprise	Continuous innovation and development
2007	European Powerboat of the Year	Superhawk 43	2000	The Times Exporter of the Year	Times Export Awards
2007	Asia Pacific Boating Awards	90 Yacht, Best of the Best	2000	Robb Report Award	Best of the Best, Boating and Sailing
2007	Modern Boating Magazine 2007	Portofino 47, Imported Powerboat of the Year	1999	Robb Report Award	Best of the Best, Boating and Sailing
2007	Australian Marine Industries Federation Awards	Predator 62, Imported Powerboat of the Year	1999	Motorboat of the Year	Predator 75, BT British Nautical Awards
2007	Nominated by The Superyacht Society	37 Metre Yacht 'The Snapper'	1998	Superyacht Design Award	Manhattan 74, Superyacht Design Awards
2007	Queen's Award for Enterprise	International Trade	1998	Editor in Chief Awards	Yachts Magazine
2006	Nominated for three Superyacht Awards	Predator 108 'SHIVER'	1997	Lifetime Achievement Award	Robert Braithwaite MBE, RYA Awards
2005	Australian Marine Industries Federation Awards	75 Yacht, Non-Trailable Boat Award	1996	Motorcruiser of the Year Award	RYA British Nautical Awards
2005	Australian Marine Industries Federation Awards	Portofino 46, Commendation	1996	Exporter of the Year Award	DCCI Export Awards
2005	Modern Boating, Power Boat of the Year Awards	Predator 68, Imported Powerboat of the Year	1995	Boat Builder of the Year Award	RYA/BMIF British Nautical Awards
2005	Boats.com Marine Industry Web Awards	Manufacturers Category for www.sunseeker.com	1994	Queen's Award for Export Achievement	Queen's Awards for Industry
2004	Sydney Boat Show 2004	Best Overall Display	1992	Best in the World Award	Renegade 60, Boating Magazine
2004	Sydney Boat Show 2004	Best Marina Display	1990	Exporter of the Year	SW International Business Awards
2003	Australian Marine Awards	Manhattan 56, Award for Excellence	1989	Queen's Award for Export Achievement	Queen's Awards for Industry
2003	Australian Marine Awards	Predator 68, Best Imported Non-Trailable Yacht	1987	Queen's Award for Export Achievement	Queen's Awards for Industry

**Naval architects**  
Don Shead/Sunseeker Design

**Exterior styling**  
Sunseeker Design

**Interior design**  
Sunseeker Design/Design Unlimited

**Builder**  
Sunseeker International

\*Every attempt has been made to give accurate information, but performance and range figures are estimates given as a guide only. Dirt or growth on the hull, tuning of the engines, size, make of engines fitted, damage to propellers, the temperature of the air and water, the weight of fuel, water, stores, number of people, propeller pitch, quality of fuel and other matters, can all affect a boat's performance and range. For these and other reasons we can give no performance, range or other guarantees, and neither such guarantees nor anything contained herein constitutes an offer of contract or any representation or agreement, or may otherwise be relied upon. The photographs and artist's impressions in this brochure are of existing models in the Sunseeker range. There may be items shown in these photographs and artist's impressions that are not included in the standard inventory of the models shown. Specifications contained on the website are samples only and should not be relied upon and may refer to models only intended for sale in a particular territory and not generally. No guarantee is given that any model will be available in any territory; however by contacting us we can advise you of models that are likely to be available in each territory. Actual specifications will be provided when a sales order or enquiry is placed with us or our approved Sunseeker dealer. Specifications for models sold in different markets may vary and specifications and models may be changed or withdrawn at any time without prior notice. The individual specification for each vessel will be agreed as part of the sale contract between the purchaser and the Sunseeker dealer. Dealers and distributors are independently owned and operated entities, and therefore Sunseeker dealers and distributors are not owned by Sunseeker International Limited or any subsidiaries or other related entity of this company nor are they their agents. Therefore they have absolutely no authority to commit Sunseeker International Limited, or any subsidiary or other related entities of Sunseeker International Limited to any pledge, contract or agreement in any form or by any means unless first accepted in writing by Sunseeker International Limited. In some examples herein Sunseeker have referred to measurements, specifications or other details applicable to a particular territory and no guarantee is given that these are applicable to your territory. For ease of reference we have, in some cases, referred to "we" or "Sunseeker" and these terms should be taken to mean Sunseeker International Limited.

Designed, written and produced by Marketing Matters Limited. Printed in Italy, November 2009. ©Sunseeker International.